



**KJELLBERG<sup>®</sup>**

系統: HiFocus 280i-360i-440i<sup>®</sup>

割槍: PerCut 370.2M - 切割可達到 440A

YellowXLife

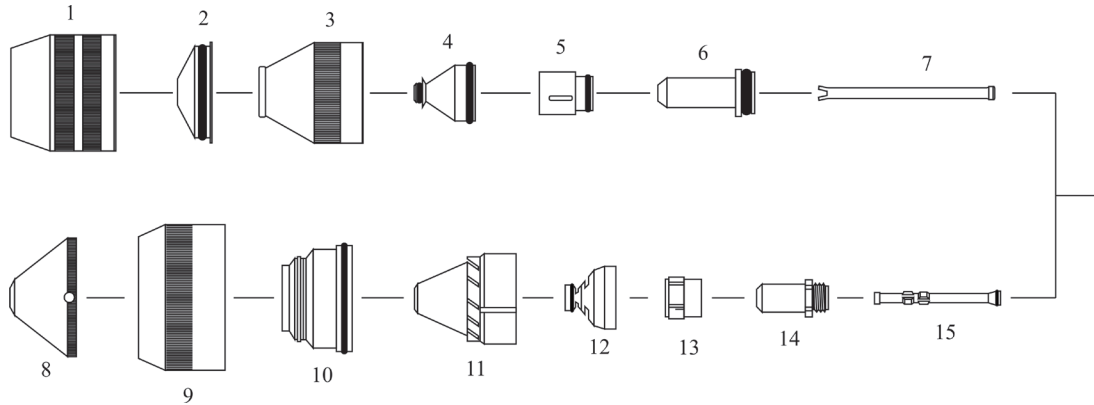

| 項目  | 參考編號              | 訂單編號            | 說明描述                            |
|-----|-------------------|-----------------|---------------------------------|
| 08. | .11.833.101.150   | BP-30702        | 屏蔽 V4330 - 3,0mm (干切割)          |
|     | .11.833.101.155   | BP-30703        | 屏蔽 V4335 - 3,5mm (干切割)          |
|     | .11.833.101.156   | BP-30704        | 屏蔽 V4340 - 4,0mm (干切割)          |
|     | .11.833.101.157   | BP-30705        | 屏蔽 V4345 - 4,5mm (干切割)          |
|     | .11.833.101.158   | BP-30706        | 屏蔽 V4350 - 5,0mm (干切割)          |
|     | .11.833.101.159   | BP-30707        | 屏蔽 V4360 - 6,0mm (干切割)          |
|     | 09.               | .11.841.721.081 | BP-30708                        |
| 10. | .11.836.901.271   | BP-30709        | 旋流 噴嘴 T521 "OEM"                |
|     | .11.836.921.271   | BP-30710        | 旋流 噴嘴 T522 "OEM"                |
| 11. | .11.836.901.163   | BP-30711        | 固定帽 T3030 - 30 CW               |
|     | .11.836.901.164   | BP-30712        | 固定帽 T3045 - 45 CW               |
|     | .11.836.901.1641  | BP-30713        | 固定帽 T3145 - 45 CCW              |
|     | .11.836.901.165   | BP-30714        | 固定帽 T3060 - 60 CW               |
|     | .11.836.901.1651  | BP-30715        | 固定帽 T3160 - 60 CCW              |
| 12. | .11.846.921.415   | BP-30729        | 噴嘴 T2115Y - 1,5mm, 120A, O2     |
|     | .11.846.921.420   | BP-30730        | 噴嘴 T2120Y - 2,0mm, 200A, O2     |
|     | .11.846.921.425   | BP-30731        | 噴嘴 T2125Y - 2,5mm, 250A, O2     |
|     | .11.846.921.427   | BP-30732        | 噴嘴 T2127Y - 2,7mm, 300A, O2     |
|     | .11.846.921.430   | BP-30733        | 噴嘴 T2130Y - 3,0mm, 360A, O2     |
| 13. | .11.836.921.153   | BP-30721        | 渦流環 T101 - (6x0,8 CW) / (特氟龍 )  |
|     | .11.836.921.154   | BP-30722        | 渦流環 T102 - (3x0,6 CW) / (特氟龍 )  |
|     | .11.836.921.1542  | BP-30723        | 渦流環 T104 - (3x0,4 CW) / (特氟龍 )  |
|     | .11.836.921.1531  | BP-30724        | 渦流環 T111 - (6x0,8 CCW) / (特氟龍 ) |
|     | .11.836.921.1541  | BP-30725        | 渦流環 T112 - (3x0,6 CCW) / (特氟龍 ) |
| 14. | .11.844.921.300AG | BP-30735        | 負電極 T012Y O2 銀                  |
| 15. | .11.844.901.152   | BP-30736        | 冷卻管 - T902Y "OEM"               |