



**KJELLBERG®**

2014 में नया

प्रणाली: HiFocus 280i-360i-440i®

मशाल: PerCut 440, PerCut 450® G line parts

कटाई: 280A-400A

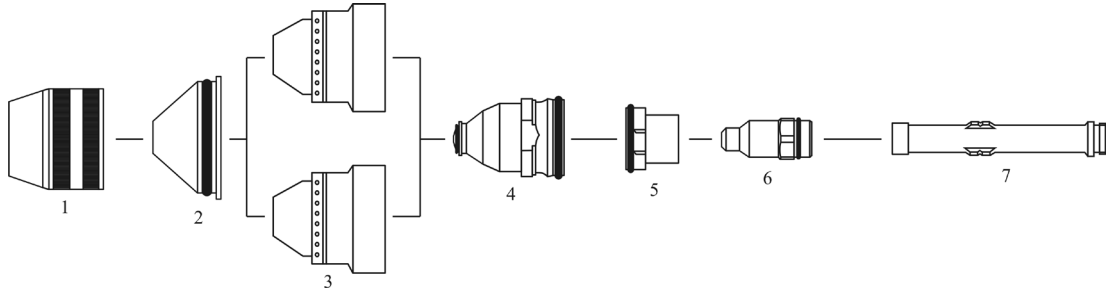

आइटम	रेफरी. नंबर	आदेश संख्या	विवरण
01.	.11.848.401.081	BP-30928	शील्ड कैप G521
02.	.11.848.401.1535	BP-30929	शील्ड G4335 - ø 3,5mm
	.11.848.401.1540	BP-30930	शील्ड G4340 - ø 4,0mm
	.11.848.401.1545	BP-30931	शील्ड G4345 - ø 4,5mm
	.11.848.401.1550	BP-30932	शील्ड G4350 - ø 5,0mm
	.11.848.401.1555	BP-30933	शील्ड G4355 - ø 5,5mm
04.	.11.848.401.1608	BP-30935	बनाए रखने कैप G3208 (Different from OEM design)
	.11.848.401.1609	BP-30936	बनाए रखने कैप G3209 (Different from OEM design)
	.11.848.401.1619	BP-30937	बनाए रखने कैप G3219 (Different from OEM design)
	.11.848.401.1628	BP-30938	बनाए रखने कैप G3228 (Different from OEM design)
	.11.848.401.1629	BP-30939	बनाए रखने कैप G3229 (Different from OEM design)
	.11.848.401.1648	BP-30940	बनाए रखने कैप G3248 (Different from OEM design)
	.11.848.401.1649	BP-30941	बनाए रखने कैप G3249 (Different from OEM design)
05.	.11.848.421.424	BP-30942	नोक G2324Y - ø 2,4mm, 240A, O2 (Different from OEM design)
	.11.848.421.426	BP-30943	नोक G2326Y - ø 2,6mm, 280A, O2 (Different from OEM design)
	.11.848.421.427	BP-30944	नोक G2327Y - ø 2,7mm, 320A, O2 (Different from OEM design)
	.11.848.421.430	BP-30945	नोक G2330Y - ø 3,0mm, 360A, O2 (Different from OEM design)
	.11.848.421.431	BP-30946	नोक G2331Y - ø 3,1mm, 400A, O2 (Different from OEM design)
	.11.848.421.432	BP-30947	नोक G2332Y - ø 3,2mm, 440A, O2 (Different from OEM design)
06.	.11.848.421.145	BP-30948	भंवर रगि G121 (वेस्पेल®)
	.11.848.421.149	BP-30949	भंवर रगि G125 (वेस्पेल®)
07.	.11.848.421.310AG	BP-30950	कैथोड G032Y O2 SILVER
	.11.848.421.330AG	BP-30951	कैथोड G034Y O2 SILVER
08.	.11.848.401.142	BP-30952	ठंडा ट्यूब G931Y