

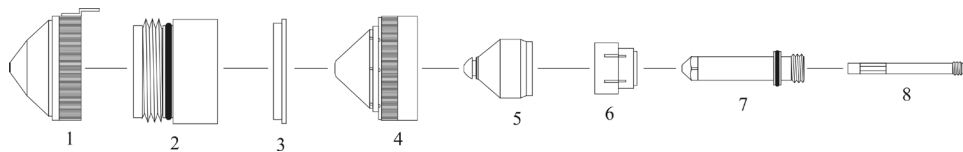

**ESAB<sup>®</sup> (L-TEC<sup>®</sup>)**

System: **PRECISION PLASMARC<sup>®</sup>**

Torch: **PT-24<sup>®</sup>**



ITEM	REF. NUMBER	ORDER NUMBER	DESCRIPTION
01.	22531	BP-10101	Shield cap 15A-100A
02.	21712	BP-10102	Insulator shield retainer 15A-100A
03.	22010	BP-10103	Insulator ring 15A-100A
04.	22007	BP-10104	Retaining cap 15A-100A
05.	21540	BP-10105	Nozzle "A" 15A
	21541	BP-10106	Nozzle "B" 30A
	21542	BP-10107	Nozzle "C" 50A
	21543	BP-10108	Nozzle "D" 70A
	21923	BP-10109	Nozzle "E" 100A
06.	21852	BP-10110	Swirl ring 15A - 2 holes (vespel <sup>®</sup> )
	21536	BP-10111	Swirl ring 30A - 3 holes (vespel <sup>®</sup> )
	21692	BP-10112	Swirl ring 50A-100A - 4 holes (vespel <sup>®</sup> )
07.	21539	BP-10113	Electrode 15A-100A
08.	21725	BP-10115	Cooling tube - PT-24 <sup>®</sup>