



**KJELLBERG<sup>®</sup>**

**NEW IN 2014**

System: **HiFocus 280i-360i-440i<sup>®</sup>**

Torch: **PerCut 440, PerCut 450<sup>®</sup> G line parts**  
cutting 280A-400A

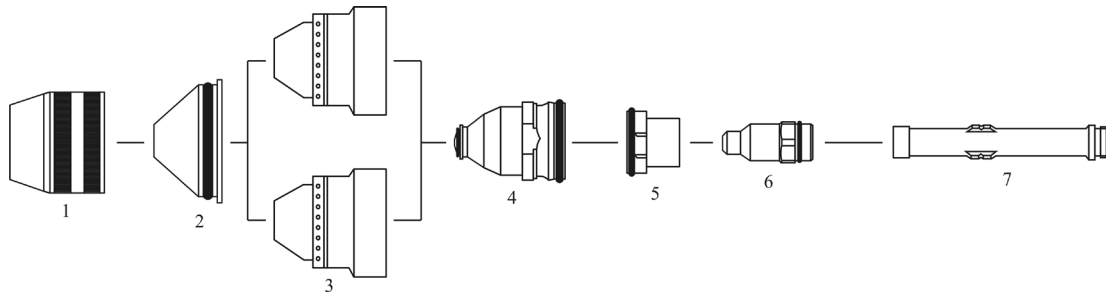

ITEM	REF. NUMBER	ORDER NUMBER	DESCRIPTION
01.	.11.848.401.081	BP-30928	Shield cap G521
02.	.11.848.401.1535	BP-30929	Shield G4335 - ø 3,5mm
	.11.848.401.1540	BP-30930	Shield G4340 - ø 4,0mm
	.11.848.401.1545	BP-30931	Shield G4345 - ø 4,5mm
	.11.848.401.1550	BP-30932	Shield G4350 - ø 5,0mm
	.11.848.401.1555	BP-30933	Shield G4355 - ø 5,5mm
04.	.11.848.401.1608	BP-30935	Retaining cap G3208 (Different from OEM design)
	.11.848.401.1609	BP-30936	Retaining cap G3209 (Different from OEM design)
	.11.848.401.1619	BP-30937	Retaining cap G3219 (Different from OEM design)
	.11.848.401.1628	BP-30938	Retaining cap G3228 (Different from OEM design)
	.11.848.401.1629	BP-30939	Retaining cap G3229 (Different from OEM design)
	.11.848.401.1648	BP-30940	Retaining cap G3248 (Different from OEM design)
	.11.848.401.1649	BP-30941	Retaining cap G3249 (Different from OEM design)
05.	.11.848.421.424	BP-30942	Nozzle G2324Y - ø 2,4mm, 240A, O2 (Different from OEM design)
	.11.848.421.426	BP-30943	Nozzle G2326Y - ø 2,6mm, 280A, O2 (Different from OEM design)
	.11.848.421.427	BP-30944	Nozzle G2327Y - ø 2,7mm, 320A, O2 (Different from OEM design)
	.11.848.421.430	BP-30945	Nozzle G2330Y - ø 3,0mm, 360A, O2 (Different from OEM design)
	.11.848.421.431	BP-30946	Nozzle G2331Y - ø 3,1mm, 400A, O2 (Different from OEM design)
	.11.848.421.432	BP-30947	Nozzle G2332Y - ø 3,2mm, 440A, O2 (Different from OEM design)
06.	.11.848.421.145	BP-30948	Swirl ring G121 (vespel <sup>®</sup> )
	.11.848.421.149	BP-30949	Swirl ring G125 (vespel <sup>®</sup> )
07.	.11.848.421.310AG	BP-30950	Cathode G032Y O2 <b>SILVER</b>
	.11.848.421.330AG	BP-30951	Cathode G034Y O2 <b>SILVER</b>
08.	.11.848.401.142	BP-30952	Cooling tube G931Y