



B & B[®]
BARTONI
CUTTING CONSUMABLES



KJELLBERG[®]

Sistema: *FineFocus 800-900-1600[®]*

Tocha: *PB-S80 W (dry cutting, underwater cutting)*

PB-S100 WU (underwater cutting)

PB-S151 W (dry cutting)

YellowXLife

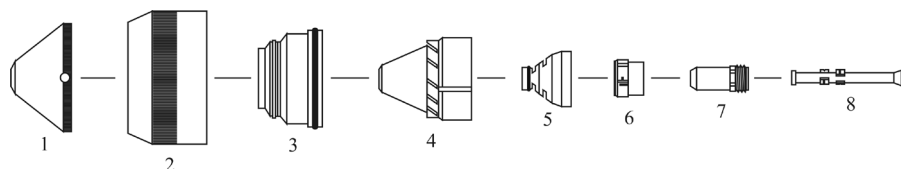

ITEM	REF. NUMERO	PEDIDO NUMERO	DESCRIÇÃO
01.	.11.833.101.150	BP-30702	Proteção V4330 - ø 3,0mm (dry cutting)
	.11.833.101.155	BP-30703	Proteção V4335 - ø 3,5mm (dry cutting)
	.11.833.101.156	BP-30704	Proteção V4340 - ø 4,0mm (dry cutting)
	.11.833.101.157	BP-30705	Proteção V4345 - ø 4,5mm (dry cutting)
	.11.833.101.158	BP-30706	Proteção V4350 - ø 5,0mm (dry cutting)
	.11.833.101.159	BP-30707	Proteção V4360 - ø 6,0mm (dry cutting)
02.	.11.841.721.081	BP-30708	Tampa Proteção T502 "OEM"
03.	.11.836.901.271	BP-30709	Bico Gás Rotativo T521 "OEM"
	.11.836.921.271	BP-30710	Bico Gás Rotativo T522 "OEM"
04.	.11.836.901.163	BP-30711	Capa do bico T3030 - 30 CW
	.11.836.901.164	BP-30712	Capa do bico T3045 - 45 CW
	.11.836.901.1641	BP-30713	Capa do bico T3145 - 45 CCW
	.11.836.901.165	BP-30714	Capa do bico T3060 - 60 CW
	.11.836.901.1651	BP-30715	Capa do bico T3160 - 60 CCW
05.	.11.846.921.415	BP-30729	Bico T2115Y - ø 1,5mm, 120A, O2
	.11.846.921.420	BP-30730	Bico T2120Y - ø 2,0mm, 200A, O2
	.11.846.921.425	BP-30731	Bico T2125Y - ø 2,5mm, 250A, O2
	.11.846.921.427	BP-30732	Bico T2127Y - ø 2,7mm, 300A, O2
	.11.846.921.430	BP-30733	Bico T2130Y - ø 3,0mm, 360A, O2
06.	.11.836.921.153	BP-30721	Distribuidor de gás T101 - (6x0,8 CW) / (teflon [®])
	.11.836.921.154	BP-30722	Distribuidor de gás T102 - (3x0,6 CW) / (teflon [®])
	.11.836.921.1542	BP-30723	Distribuidor de gás T104 - (3x0,4 CW) / (teflon [®])
	.11.836.921.1531	BP-30724	Distribuidor de gás T111 - (6x0,8 CCW) / (teflon [®])
	.11.836.921.1541	BP-30725	Distribuidor de gás T112 - (3x0,6 CCW) / (teflon [®])
07.	.11.844.921.300AG	BP-30735	Catodo T012Y O2 SILVER
08.	.11.844.901.152	BP-30736	Tubo de água - T902Y "OEM"