

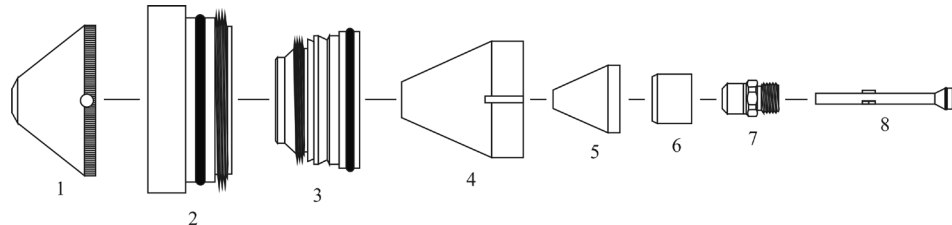

**KJELLBERG<sup>®</sup>**

Sistema: PA-S50-75-76-77-150 W<sup>®</sup>

Tocha: PB-S70 W<sup>®</sup>



ITEM	REF. NUMERO	PEDIDO NUMERO	DESCRIÇÃO
01.	.11.833.101.150	BP-30702	Proteção V4330 - ø 3,0mm (dry cutting)
	.11.833.101.155	BP-30703	Proteção V4335 - ø 3,5mm (dry cutting)
	.11.833.101.156	BP-30704	Proteção V4340 - ø 4,0mm (dry cutting)
	.11.833.101.157	BP-30705	Proteção V4345 - ø 4,5mm (dry cutting)
	.11.833.101.158	BP-30706	Proteção V4350 - ø 5,0mm (dry cutting)
	.11.833.101.159	BP-30707	Proteção V4360 - ø 6,0mm (dry cutting)
02.	.11.833.101.261	BP-30801	Tampa Proteção V501 "OEM"
	.11.828.401.265	BP-30802	Tampa Proteção "OEM"
03.	.11.833.101.271	BP-30803	Bico Gás Rotativo V521
	.11.828.401.275	BP-30804	Bico Gás Rotativo "OEM"
04.	.12.37790	BP-30805	Capa do bocal - ø 38mm
05.	.11.828.501.414	BP-30806	Bico L1 - ø 1,4mm, 120A, Air
	.12.43050	BP-30807	Bico L1 - ø 2,0mm, 160A, Air
	.12.40850	BP-30808	Bico L2 - ø 2,5mm, 250A, Air
	.11.828.501.427	BP-30809	Bico L4 - ø 2,7mm, 300A, Air
	.11.828.901.414	BP-30810	Bico L3-XL - ø 1,4mm, 120A, O2
	.11.828.901.420	BP-30811	Bico L1-XL - ø 2,0mm, 160A, O2
	.11.828.901.425	BP-30812	Bico L2-XL - ø 2,5mm, 250A, O2
	.11.828.901.427	BP-30813	Bico L4-XL - ø 2,7mm, 300A, O2
06.	.12.40860	BP-30814	Distribuidor de gás / (teflon <sup>®</sup> )
07.	.12.40870	BP-30815	Catodo K2 Air
	.11.828.921.300AG	BP-30816	Catodo K2-XL O2 <b>SILVER</b>
	.11.833.121.300AG	BP-30817	Catodo K3-XL O2 <b>SILVER</b>
08.	.12.51440	BP-30818	Tubo de água - PB-S50-75-76-77-150 "OEM"
	.11.836.901.152	BP-30727	Tubo de água - T901 "OEM"