



**B & B<sup>®</sup>**  
**BARTONI**  
CUTTING CONSUMABLES

## KJELLBERG<sup>®</sup>

Sistem: PA-S50-75-76-77-150 W<sup>®</sup>

Torch: PB-S70 W<sup>®</sup>

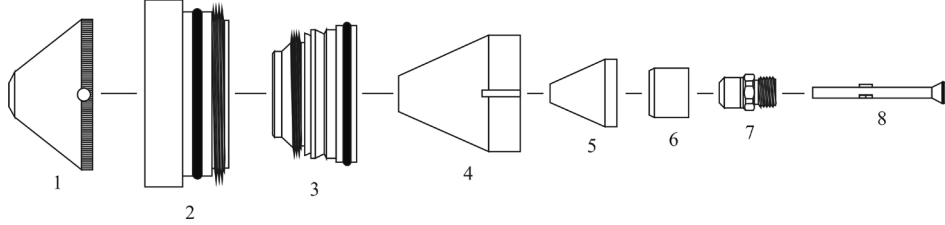

PARÇA	REFERANS NUM.	SİPARİŞ NUM.	TANIM
01.	.11.833.101.150	BP-30702	Shield V4330 - ø 3,0mm (KURU KESİM)
	.11.833.101.155	BP-30703	Shield V4335 - ø 3,5mm (KURU KESİM)
	.11.833.101.156	BP-30704	Shield V4340 - ø 4,0mm (KURU KESİM)
	.11.833.101.157	BP-30705	Shield V4345 - ø 4,5mm (KURU KESİM)
	.11.833.101.158	BP-30706	Shield V4350 - ø 5,0mm (KURU KESİM)
	.11.833.101.159	BP-30707	Shield V4360 - ø 6,0mm (KURU KESİM)
02.	.11.833.101.261	BP-30801	Protective cap V501 "OEM"
	.11.828.401.265	BP-30802	Protective cap "OEM"
03.	.11.833.101.271	BP-30803	Swirl gas nozzle V521
	.11.828.401.275	BP-30804	Swirl gas nozzle "OEM"
04.	.12.37790	BP-30805	Shield cap - ø 38mm
05.	.11.828.501.414	BP-30806	Nozzle L3 - ø 1,4mm, 120A, Air
	.12.43050	BP-30807	Nozzle L1 - ø 2,0mm, 160A, Air
	.12.40850	BP-30808	Nozzle L2 - ø 2,5mm, 250A, Air
	.11.828.501.427	BP-30809	Nozzle L4 - ø 2,7mm, 300A, Air
	.11.828.901.414	BP-30810	Nozzle L3-XL - ø 1,4mm, 120A, O2
	.11.828.901.420	BP-30811	Nozzle L1-XL - ø 2,0mm, 160A, O2
	.11.828.901.425	BP-30812	Nozzle L2-XL - ø 2,5mm, 250A, O2
	.11.828.901.427	BP-30813	Nozzle L4-XL - ø 2,7mm, 300A, O2
06.	.12.40860	BP-30814	Swirl ring / (teflon <sup>®</sup> )
07.	.12.40870	BP-30815	Cathode K2 Air
	.11.828.921.300AG	BP-30816	Cathode K2-XL O2 <b>GÜMÜŞ</b>
	.11.833.121.300AG	BP-30817	Cathode K3-XL O2 <b>GÜMÜŞ</b>
08.	.12.51440	BP-30818	Cooling tube - PB-S50-75-76-77-150 "OEM"
	.11.836.901.152	BP-30727	Cooling tube - T901 "OEM"